

Addendum

Addendum No.: **001**
Date: 11/15/11

Project: **Café Espresso – Coffee Shop**
Project No.: 01-0045-065

From: Dekker/Perich/Sabatini
7601 Jefferson St. NE, Suite 100
Albuquerque, NM 87109

To: All Prospective Bidders and Plan Holders

This Addendum forms a part of the Bid Documents and modifies the Bid Documents issued by Dekker/Perich/Sabatini (D/P/S) and dated 11/15/11. Acknowledge receipt of this Addendum on the Bid Form. Failure to do so may subject the Bidder to disqualification. All other provisions of the Bid Documents shall remain unchanged.

1. SPECIFICATIONS:

1.1. 00300-Bid Form

1.1.1. **Replace** existing specification section with attached version.

2. DRAWINGS:

2.1. AE101

2.1.1. **Remove** casework filler piece, furr out wall to 6" width at end receiving security grille. Refer to SKA-001 and related plan detail.

2.1.2. **Revise** reflected ceiling plan to receive un-perforated vinyl tile in food preparation/cleaning area. Added 1'-0" wide soffit above checkout counter. Refer to attached SKA-002 and SKA-003.

2.2. B2/AE301

2.2.1. **Delete** casework filler piece detail B2/AE301.

2.3. B2/AE501

2.3.1. **Add** plan detail B2/AE501 per attached SKA-004.

2.4. E101

2.4.1. **Reutilize** existing exit signage per attached SKE101a.

All other provisions of the Contract Documents shall remain unchanged. This addendum is hereby made a part of the Contract Documents to the same extent as those provisions contained in the original documents and all itemized listings thereof.

End of Addendum

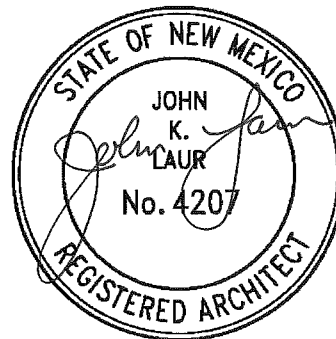

Presbyterian Hospital
Café Espresso Coffee Shop
Albuquerque, New Mexico

SECTION 00300
BID FORM

BY (CONTRACTOR) _____

(ADDRESS) _____

To Presbyterian Healthcare Services. (Also called "Owner")

1. The undersigned (hereinafter called "Bidder") in compliance with the invitation for bids for the construction/remodel of Presbyterian Kaseman Emergency Department Remodel, having carefully examined the contract documents and the site of the proposed work, and being familiar with all conditions surrounding the construction of the proposed project including the availability of materials and labor, hereby proposes to furnish all labor, materials, and supplies, and to construct the project in accordance with the contract documents, within the time set forth herein, and for the stipulated sum stated below. This price shall cover all expenses incurred in performing the work required under the contract documents of which this proposal is a part. All amounts shall be shown in both words and figures. In case of discrepancies, the amount shown in words will govern.

2. **Base Bid:** Bidder agrees to perform the Work described as the Base Bid in the specifications and shown on the plans for the stipulated sum of:

The Guaranteed Maximum Price for all work as defined in the Contract Documents, including Owners Contingency is:

_____ (Dollars) (\$) _____
(Excluding NMGR)(Reimbursement for NMGR will be added on certificates for payment)

3. **Alternate Number One:** Bidder agrees to perform the Work described as Alternate Number One in Section 01230 and shown on the plans for the lump sum price of:

_____ (Dollars) (\$) _____
(including NMGR - Reimbursement for NMGR will be added on certificates for payment)

6. The Total **Base Bid** breaks down as follows (use only necessary categories):

General Conditions	\$ _____
Demolition	\$ _____
Concrete Work	\$ _____
Rough Carpentry	\$ _____
Architectural Casework	\$ _____
Building Insulation	\$ _____
Joint Sealants	\$ _____
Fire stopping	\$ _____
Water proofing	\$ _____
Hardware	\$ _____
Glass, Glazing, Storefront & Curtain Wall	\$ _____
Metal Stud & Drywall	\$ _____
Acoustical Ceiling	\$ _____
Flooring	\$ _____

**Presbyterian Hospital
Café Espresso Coffee Shop
Albuquerque, New Mexico**

Painting	\$ _____
Specialties	\$ _____
HVAC	\$ _____
HVAC Controls	\$ _____
Plumbing	\$ _____
Fire Protection	\$ _____
Electrical	\$ _____
Fire Alarm	\$ _____
<u>Sub-Total</u>	\$ _____
Workers Compensation	\$ _____
Liability Insurance	\$ _____
Builders Risk	\$ _____
OH&P	\$ _____
<u>Sub-Total</u>	\$ _____
Owner's Contingency	\$ _____ 7,500.00
<u>Guaranteed Maximum Price</u>	\$ _____
(Excluding NMGRT)	
Estimated NMGRT	\$ _____

7. Sub-Contractor List:

Item	Contractor Name
Demolition	_____
Concrete Work	_____
Rough Carpentry	_____
Architectural Casework	_____
Building Insulation	_____
Joint Sealants	_____
Fire stopping	_____
Water proofing	_____
Hardware	_____
Glass, Glazing, Storefront & Curtain Wall	_____
Metal Stud & Drywall	_____
Acoustical Ceiling	_____
Flooring	_____
Painting	_____
Specialties	_____
HVAC	_____

**Presbyterian Hospital
Café Espresso Coffee Shop
Albuquerque, New Mexico**

HVAC Controls	_____
Plumbing	_____
Fire Protection	_____
Electrical	_____
Fire Alarm	_____

8. It is anticipated that Bidder will be released to proceed on/before November 28, 2011 and therefore Bidder agrees to a date of final completion of January 27, 2011, ready for owner use. This schedule should include delivery of a final Certificate of Occupancy and Fire Marshal approval and documents forwarded to the Architect no later than January 27, 2011. If release to proceed occurs later than November 28, 2011, each calendar day past this date shall be added to the completion date. Any other factors which require completion beyond January 27, 2011 shall occur only with prior written Owner approval.

9. Addenda: The undersigned hereby acknowledges receipt of the following addenda to the drawings and project manuals, all of the provisions and requirements of which addenda have been taken into consideration in the preparation of this proposal.

Addenda No. _____ Dated _____ Addenda No. _____ Dated _____
Addenda No. _____ Dated _____ Addenda No. _____ Dated _____

10. The undersigned declares that the only person or parties interested in the bid as principals are those named herein; that the bid is made without collusion with any firm or corporation; that he has carefully examined all documents and that he has made a personal examination of the site of the work; that he is to furnish all the necessary machinery, tools, apparatus and other means of construction, and that he will do all the work and furnish all the materials specified in the manner and the time prescribed.

11. The undersigned hereby agrees to execute the said contract within five (5) days or Presbyterian Healthcare Services may allow such further time as in writing after receiving notification of acceptance of bid.

12. Bidder agrees that this Bid Proposal may not be withdrawn for a period of thirty (30) calendar days after the Bid Opening. If the contract is to be awarded, Owner will give the successful Bidder a Notice of Award within two (2) days after the Bid opening.

13. The undersigned agrees within five (5) days after the agreement is executed, to deliver to the Owner the certificates of insurance and original insurance policies required in the General Conditions.

14. This Bid Proposal is hereby respectfully submitted. The signatory hereto certifies and warrants that he/she has full authority to submit this Bid Proposal on behalf of Bidder.

(Name of Bidder) (Type or Print)
(Specify if sole proprietorship, partnership,
or corporation, and state of incorporation)

By: _____
(Signature)

_____ Date
Corporate Seal:

(Name)

**Presbyterian Hospital
Café Espresso Coffee Shop
Albuquerque, New Mexico**

(Title)
(Print Name & Title of Bidder's Authorized
Representative)

(Address of Bidder)

(Bidder's New Mexico Contractor's License
No. and Classification)

(Telephone Number of Bidder)

END OF SECTION

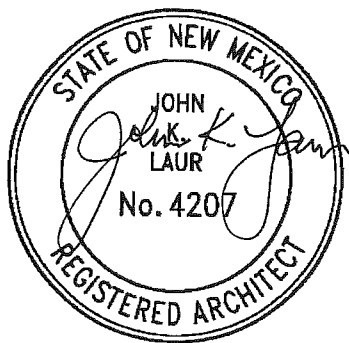
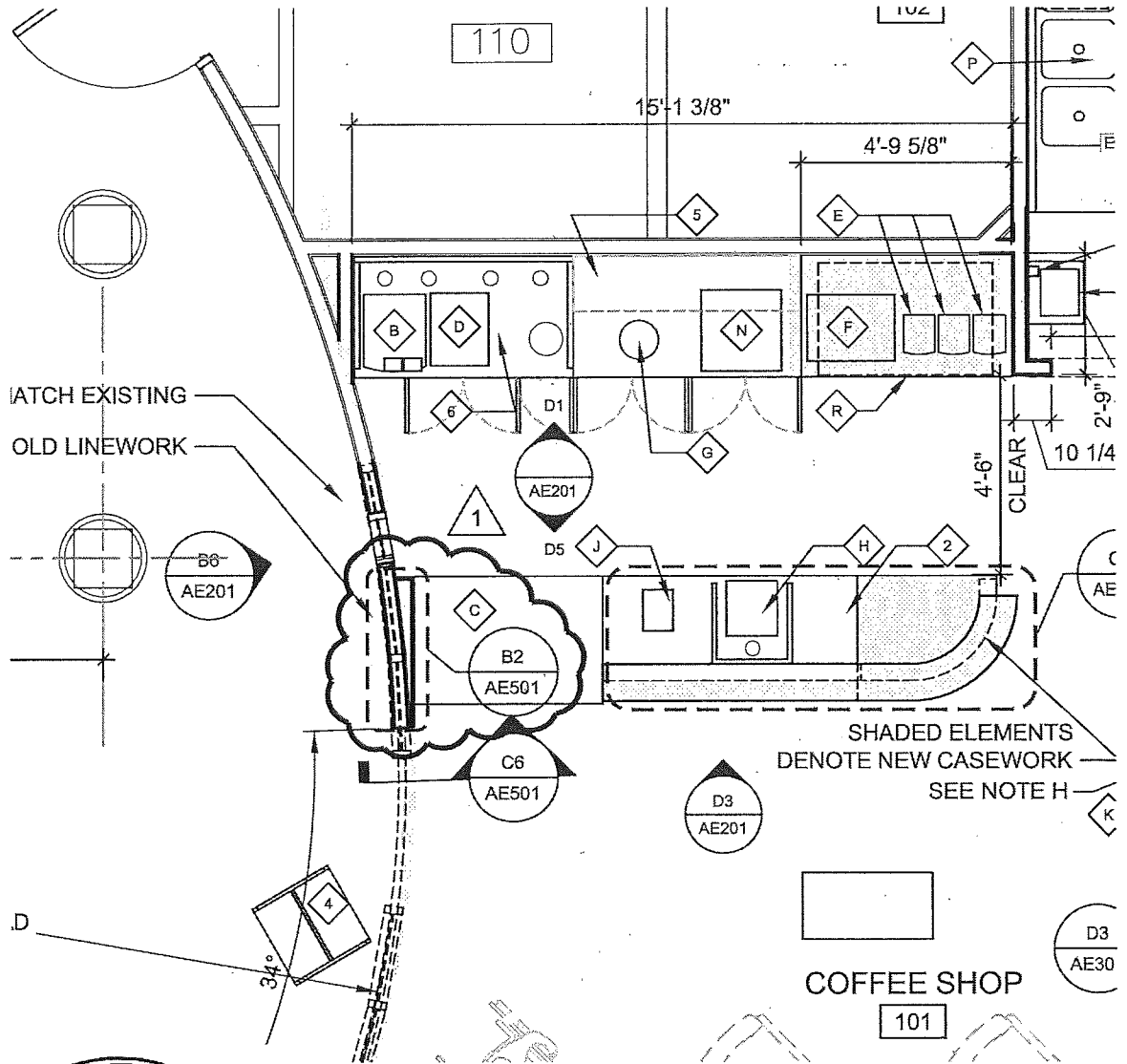

Dekker/Perich/Sabatini

architecture • interiors • landscape • planning • engineering
 7601 Jefferson NE, Suite 100 Albuquerque, NM 87109
 505 761-9700 fax 761-4222

ADDENDUM #1 CITY COMMENTS	FLOOR PLAN C3/AE101		
Presbyterian Hospital Cafe Espresso - Coffee Shop 1100 Central Ave SE Albuquerque, NM 87123	DRAWN BY	DJH	SCALE AS SHOWN
	REVIEWED BY	JKL	SKA-001 OF
	DATE ISSUED	11/15/11	
	PROJECT NO.	01-0045-065	

COMM
CENTER
109

SECRETARY
110

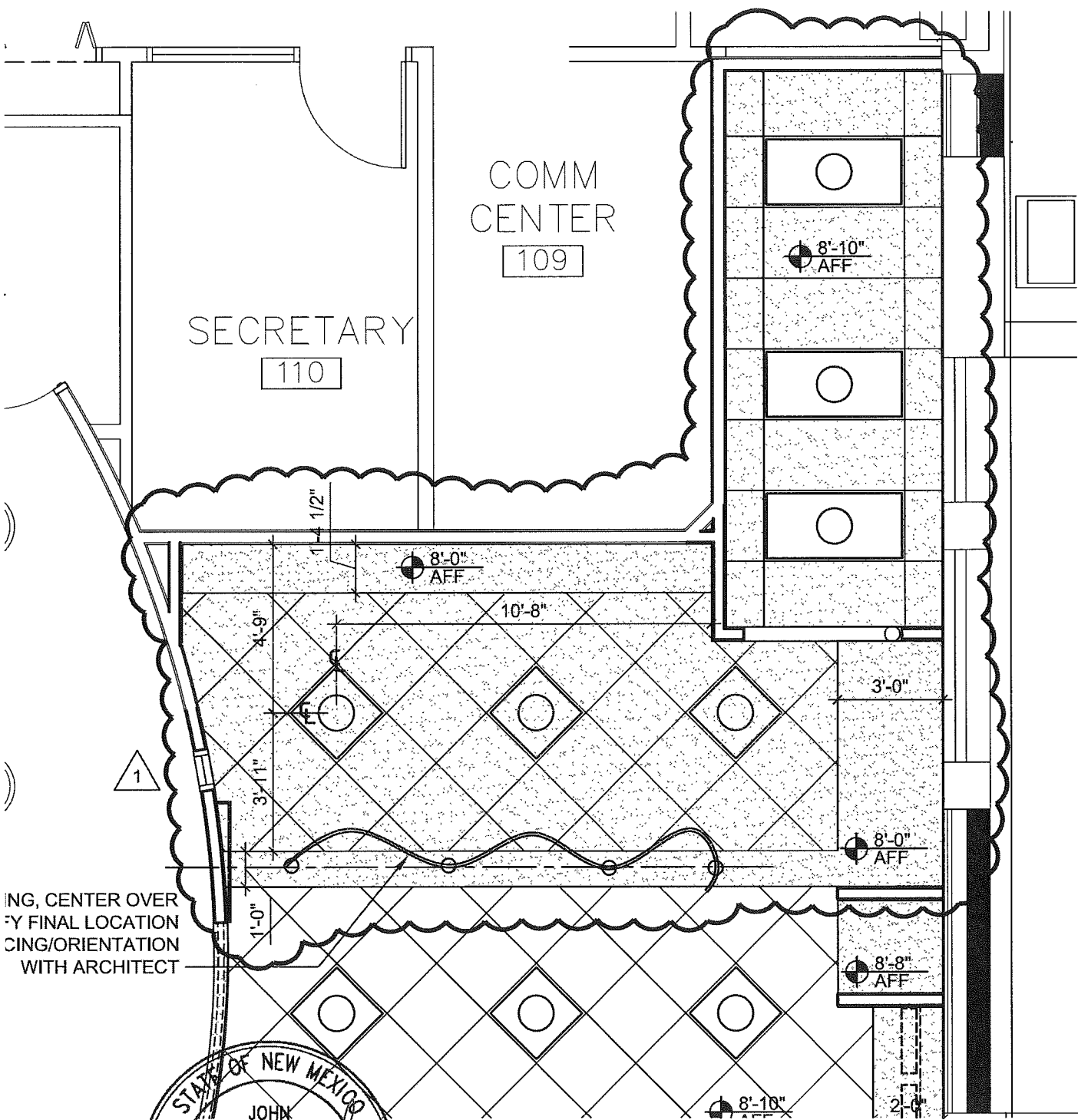

ING, CENTER OVER
Y FINAL LOCATION
CING/ORIENTATION
WITH ARCHITECT

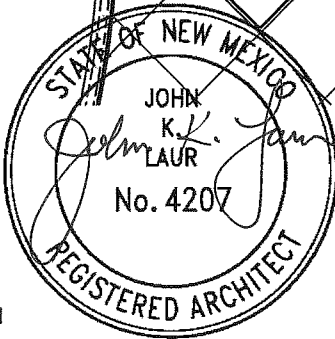

Dekker/Perich/Sabatini

architecture - interiors - landscape - planning - engineering
7601 Jefferson NE, Suite 100
Albuquerque, NM 87109
505 761-6700
fax 761-4222

ADDENDUM #1 CITY COMMENTS	REFLECTED CEILING PLAN A3/AE101		
Presbyterian Hospital Cafe Espresso - Coffee Shop 1100 Central Ave SE Albuquerque, NM 87123	DRAWN BY	DJH	SCALE AS SHOWN
	REVIEWED BY	JKL	SKA-002
	DATE ISSUED	11/15/11	
	PROJECT NO.	01-0045-065	OF

RCP LEGEND

	2'-0"x4'-0" LAY-IN SUSPENDED CEILING		2x2 LIGHT FIXTURE
	2'-0"x2'-0" LAY-IN SUSPENDED CEILING		2x4 LIGHT FIXTURE
	2'-0"x4'-0" LAY-IN SUSPENDED CEILING CLEANROOM UNPERFORATED VINYL TILE, ARMSTRONG 870 15/16		1x4 LIGHT FIXTURE
	2'-0"x2'-0" LAY-IN SUSPENDED CEILING CLEANROOM VINYL UNPERFORATED VINYL TILE, ARMSTRONG 870 15/16		1x2 LIGHT FIXTURE
	GYPSUM BOARD CEILING		PENDANT LIGHT FIXTURE

NOTE:
REFER TO A3/AE501 FOR
TYPICAL SEISMIC DETAILS



Dekker/Perich/Sabatini
 architecture - interiors - landscape - planning - engineering
 7601 Jefferson NE, Suite 100
 Albuquerque, NM 87109

505 761-9700
 fax 761-4222

ADDENDUM #1 CITY COMMENTS	REFLECTED CEILING PLAN LEGEND AE101		
Presbyterian Hospital Cafe Espresso - Coffee Shop 1100 Central Ave SE Albuquerque, NM 87123	DRAWN BY	DJH	SCALE AS SHOWN
	REVIEWED BY	JKL	SKA-003 OF
	DATE ISSUED	11/15/11	
	PROJECT NO.	01-0045-065	

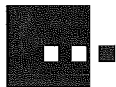
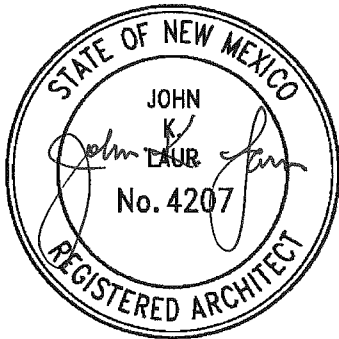
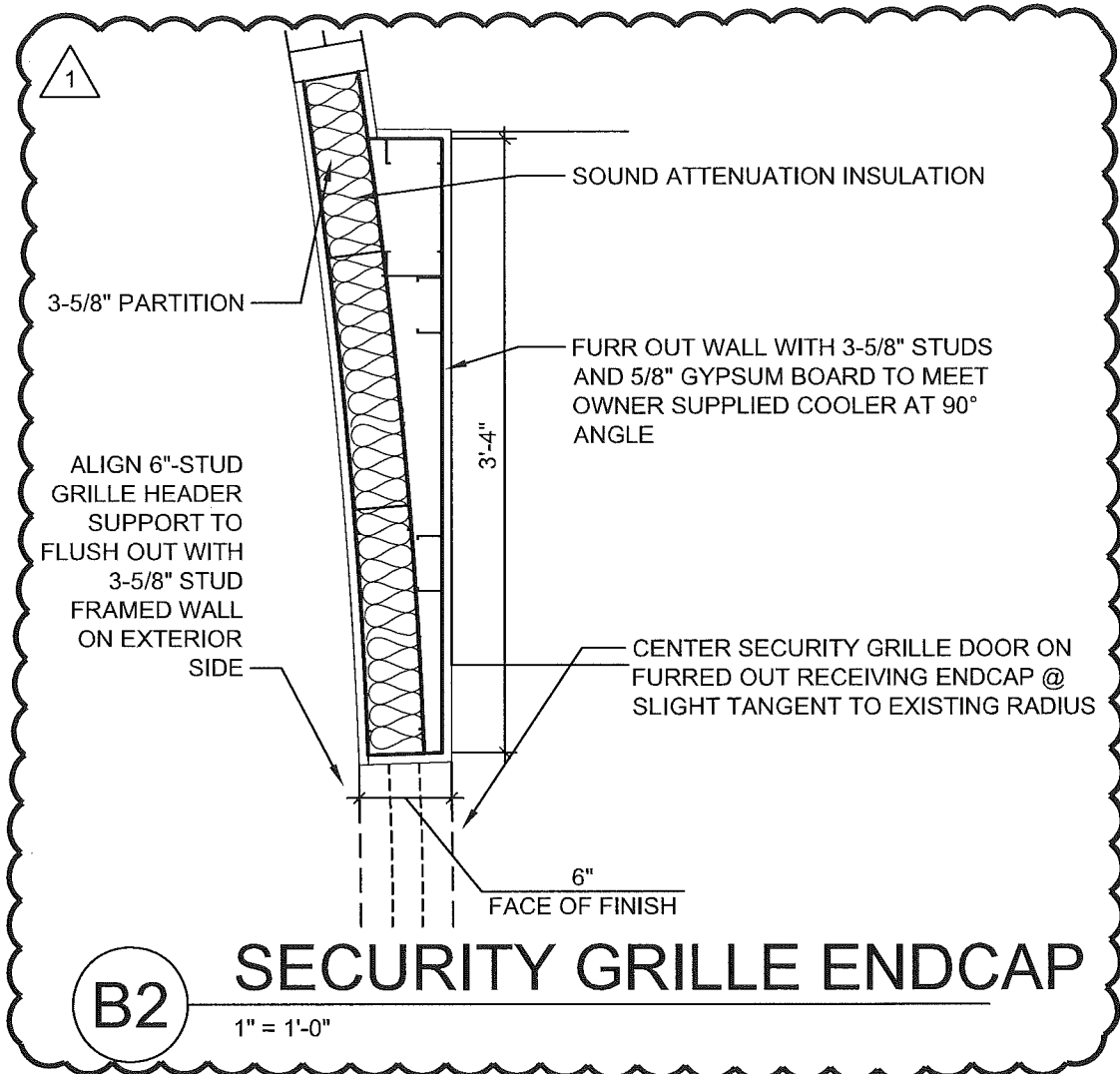

Dekker/Perich/Sabatini

architecture - interiors - landscape - planning - engineering
7601 Jefferson NE, Suite 100
Albuquerque, NM 87109

505 761-9700
fax 761-4222

ADDENDUM #1 CITY COMMENTS	DETAILS AE501	
Presbyterian Hospital Cafe Espresso - Coffee Shop 1100 Central Ave SE Albuquerque, NM 87123	DRAWN BY	DJH SCALE AS SHOWN
	REVIEWED BY	JKL
	DATE ISSUED	11/15/11
	PROJECT NO.	01-0045-065
		SKA-004 OF

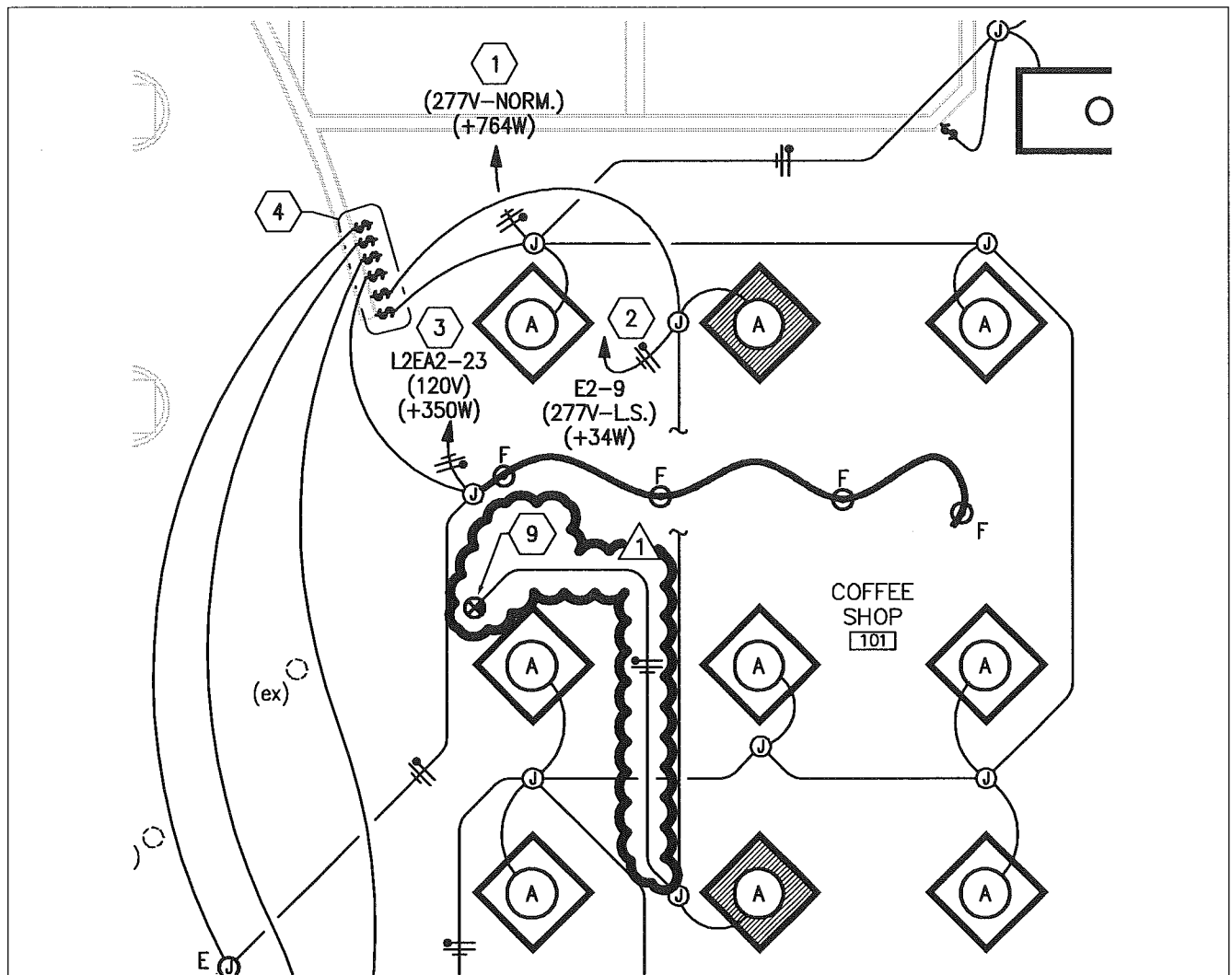

PARTIAL LIGHTING PLAN

1/4" = 1'-0"

9. REUTILIZE EXISTING EXIT SIGN REMOVED DURING DEMOLITION PHASE. REINSTALL AND RECIRCUIT AS INDICATED.

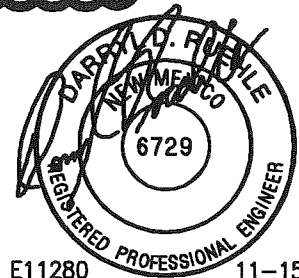

E11280

11-15-11



Dekker/Perich/Sabatini

6801 Jefferson NE
Suite 100
Albuquerque, NM 87109

architecture
interiors
planning
engineering

505 761-9700
fax 761-4222
dps@dpsabq.com

Addendum / CoA Comments
Relocated Exit Sign

Presbyterian Hospital
Cafe Espresso - Coffee Shop
1100 Central Ave SE
Albuquerque, NM

Partial Sheet E101
Partial Lighting Plan

DRAWN BY	TRG/msp	SCALE	AS SHOWN
REVIEWED BY	TRG/ddr		
DATE ISSUED	11-15-11		
PROJECT NO.	01-0045-062		

SKE101a

OF